





## Stylish Light-Filled Apartment Offering Iconic Harbour Views

Kirribilli 5/50 Upper Pitt Street

Located in the prestigious 'Gainsborough' building, this fully renovated apartment presents sophisticated open plan living and a light-filled north and south facing flow. This classic modern home encompasses iconic views, offering entertainers' decks, north facing balconies and landscaped grounds.

- Kitchen with CaesarStone benches, s/steel Bosch appliances, harbour views
- Built-in robe, balconies off bedrooms & master with walk-in robe and ensuite
- Sleek bathrooms with frameless showers, in-built cabinetry/storage & laundry
- In security building with lift access plus security parking & storage cage
- Landscaped grounds, communal pool & total convenience

Ray White Lower North Shore

2  2  1 

### Auction

Saturday 17 October 9.00am, On-Site

View Sat & Wed 11.00-11.45am

Outgoings Strata Levies: \$2,710pp

Council Rates: \$871pa (all approx)

Mary Curran 0411 178 181

mcurran@RWLNS.com

Mark Swift 0415 167 158

mswift@RWLNS.com

RWLNS.com | 9953 7333

While all care has been taken in preparing this advertisement, we make no warranty as to the accuracy, completeness or reliability of the information contained in this publication, as it may have been obtained from third parties. Buyers should seek relevant professional advice.

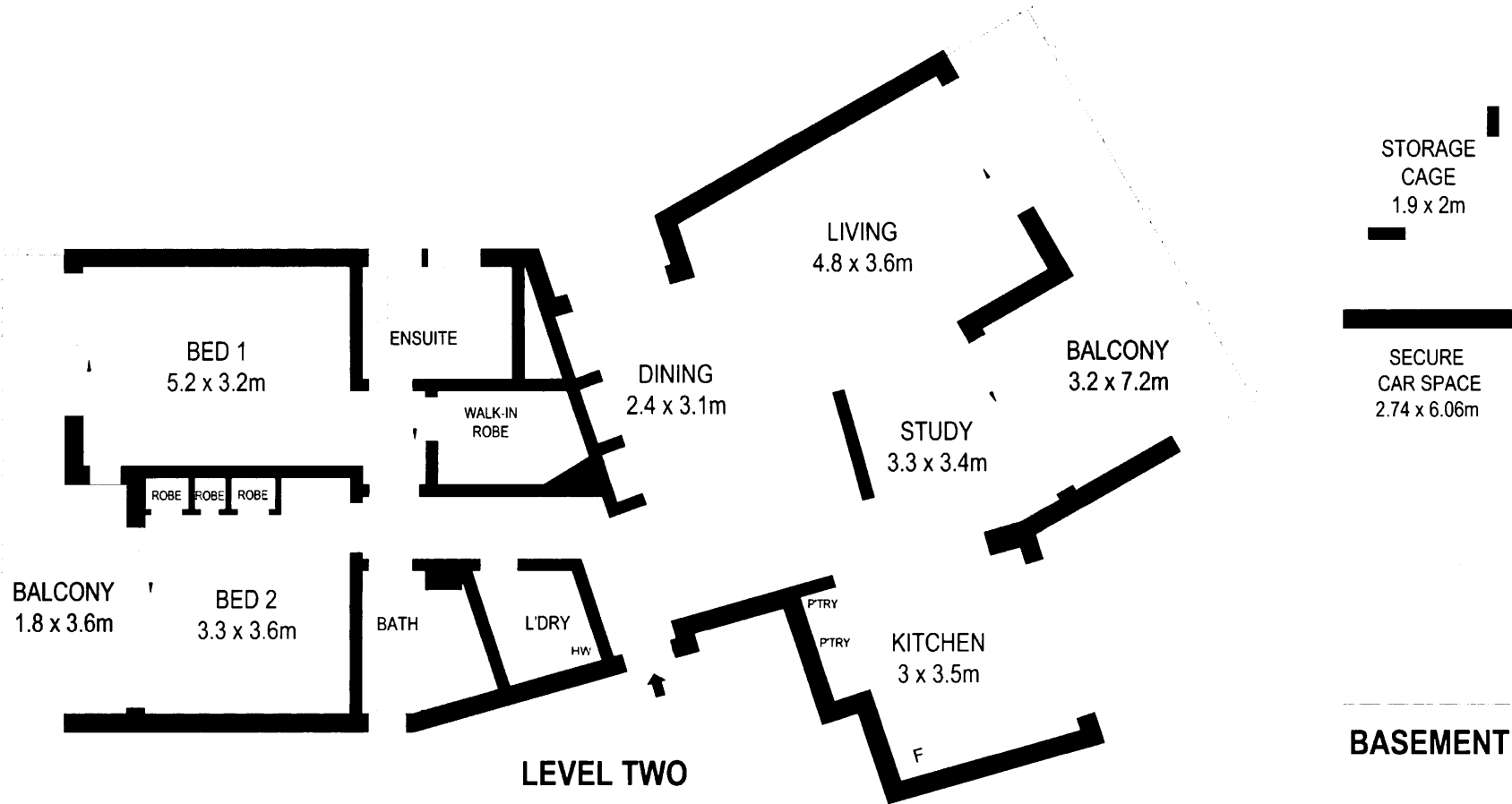

Scale in metres. Indicative only. Dimensions are approximate. All information contained herein is gathered from sources we believe to be reliable. However we cannot guarantee its accuracy and interested persons should rely on their own enquiries.

FLOOR AREA INCLUDING BALCONIES	: 141.3 m <sup>2</sup>
CAR SPACE AREA	: 16.6 m <sup>2</sup>
STORAGE ROOM AREA	: 3.9 m <sup>2</sup>
TOTAL AREA	: 161.8 m <sup>2</sup>



5/50 Upper Pitt Street, Kirribilli

**Ray White**